

Greening Richmond Public Libraries

Broad Rock Branch Library Existing Conditions



Altria



Greening Richmond Public Libraries

- The James River Association is working alongside Richmond Public Libraries, RVAH2O, and Four Winds Design to design and install **green infrastructure** practices to manage stormwater at Broad Rock Branch, North Avenue Branch, and West End Branch this year
- In-person and virtual design charrettes are scheduled during the month of July 2020 to solicit feedback on **green infrastructure** practices that could be implemented at Broad Rock Branch, North Avenue Branch, and West End Branch

What is **Stormwater Pollution**?

- Did you know stormwater is a threat to the health of the James River and its tributaries?
- When rain falls on an impervious surfaces, such as roads or sidewalks, it becomes stormwater
- If stormwater picks up pollutants such as dirt, nutrients from lawn fertilizer, bacteria from pet waste, or toxics like oil from cars as it flows across an impervious surface, it becomes **stormwater pollution**

What is **Green Infrastructure**?

- **Green infrastructure** practices include rain gardens, street trees, and conservation landscaping that enhance our built environment for the benefit of humans and the ecosystem of which we are a part
- **Green infrastructure** contributes to healthier communities by absorbing stormwater before it enters our rivers and streams, improving air quality, and reducing the urban heat island effect
- It also provides habitat for wildlife living among us



Applicable **Green Infrastructure** Practices

- Street trees
- Conservation landscaping
- Bioretention areas / rain gardens



Greening Richmond Public Libraries

IMPROVING THE HEALTH OF THE JAMES RIVER BY REDUCING STORMWATER POLLUTION

Broad Rock Branch Library

Legend:

- Downspout locations
- Water Meter
- Gas Meter
- Electric Meter
- Site Pole Lights
- Telephone Pedestal
- Clean Out
- Fire Hydrant
- Water Valve
- Irrigation Valve
- Sewer Manhole
- Storm Manhole
- Storm Inlet
- Sign
- Utility Pole

- Existing Trees & Shrubs To Be Preserved
- Existing Shrubs and Trees To Be Removed

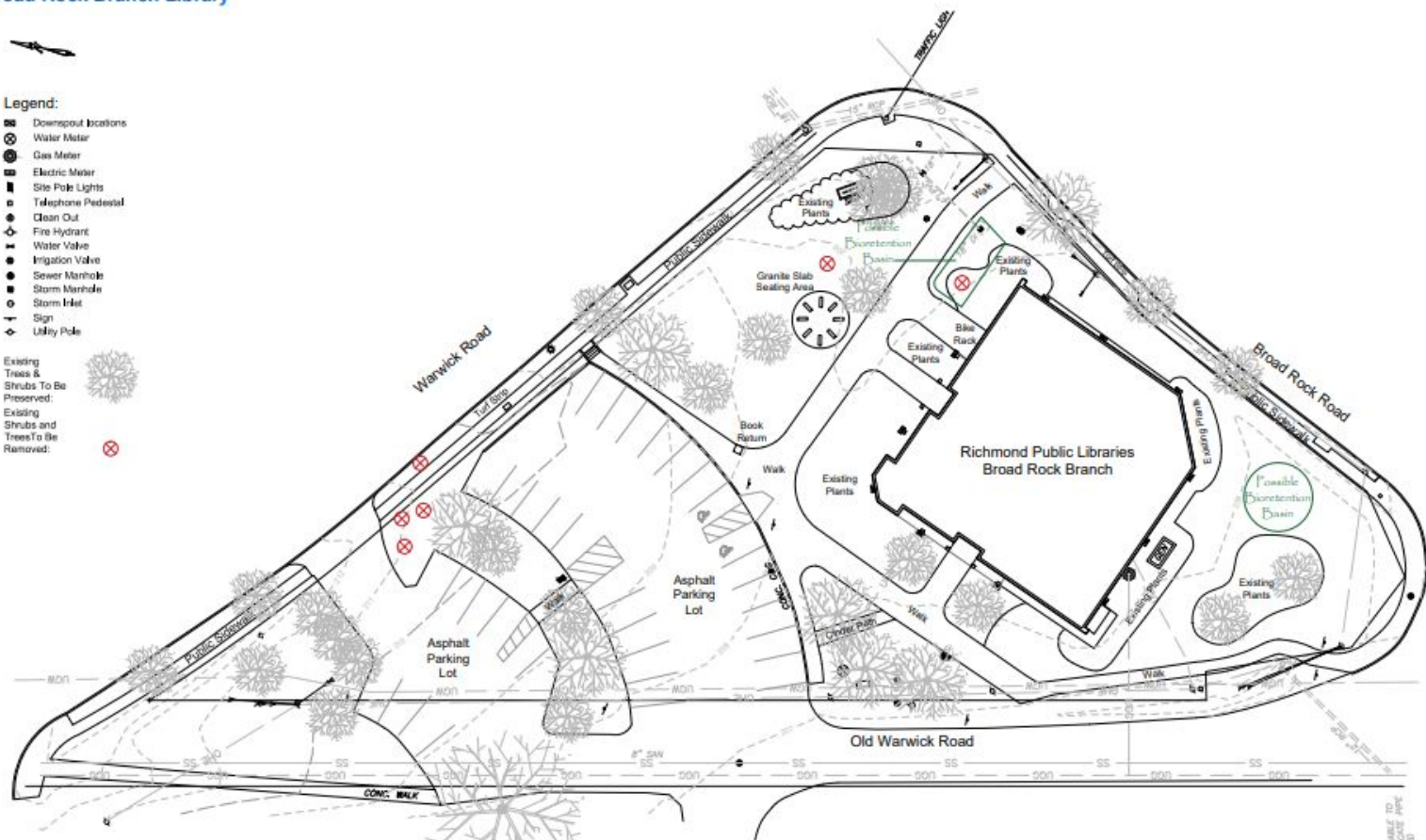

Existing Conditions - Parking Area



Existing Conditions - Main Entrance



Existing Conditions - Main Entrance



Existing Conditions - Warwick Road



Existing Conditions - Zinnias and Sunflowers



Existing Conditions - Warwick Road Entrance



Existing Conditions - Warwick Road Entrance



Existing Conditions - Broad Rock Boulevard



Existing Conditions - Old Warwick Road



Summary of Existing Conditions

- Library provides important services to residents of the 8th and 9th districts
- Library signs are obstructed by landscaping
- Main entrance to the library is not welcoming
- Existing trees on library grounds provide some shade and present an opportunity for the creation of a seating area near the main entrance
- Preferred bioretention area is located near the Warwick Road entrance
- Library window facing Broad Rock Boulevard presents an opportunity for a pollinator garden
- Opportunities to harvest stormwater from downspouts exist around the library
- Better maintenance of existing trees and shrubs is needed
- Vehicular traffic on Warwick Road and Broad Rock Boulevard is noisy