

Greening Richmond Public Libraries

North Avenue Branch Library Existing Conditions



Altria



Greening Richmond Public Libraries

- The James River Association is working alongside Richmond Public Libraries, RVAH2O, and Four Winds Design to design and install **green infrastructure** practices to manage stormwater at Broad Rock Branch, North Avenue Branch, and West End Branch this year
- In-person and virtual design charrettes are scheduled during the month of July 2020 to solicit feedback on **green infrastructure** practices that could be implemented at Broad Rock Branch, North Avenue Branch, and West End Branch

What is **Stormwater Pollution**?

- Did you know stormwater is a threat to the health of the James River and its tributaries?
- When rain falls on an impervious surfaces, such as roads or sidewalks, it becomes stormwater
- If stormwater picks up pollutants such as dirt, nutrients from lawn fertilizer, bacteria from pet waste, or toxics like oil from cars as it flows across an impervious surface, it becomes **stormwater pollution**

What is **Green Infrastructure**?

- **Green infrastructure** practices include rain gardens, street trees, and conservation landscaping that enhance our built environment for the benefit of humans and the ecosystem of which we are a part
- **Green infrastructure** contributes to healthier communities by absorbing stormwater before it enters our rivers and streams, improving air quality, and reducing the urban heat island effect.
- It also provides habitat for wildlife living among us



Applicable **Green Infrastructure** Practices

- Conservation landscaping
- Street trees
- Bioretention areas / rain gardens



Greening Richmond Public Libraries

IMPROVING THE HEALTH OF THE JAMES RIVER BY REDUCING STORMWATER POLLUTION

North Avenue Branch Library

Legend:

- Downspout Locations
- Water Meter
- Gas Meter
- Electric Meter
- Site Pole Lights
- City Street Lights

Existing Trees & Shrubs To Be Preserved:



Existing Shrubs and Trees To Be Removed:

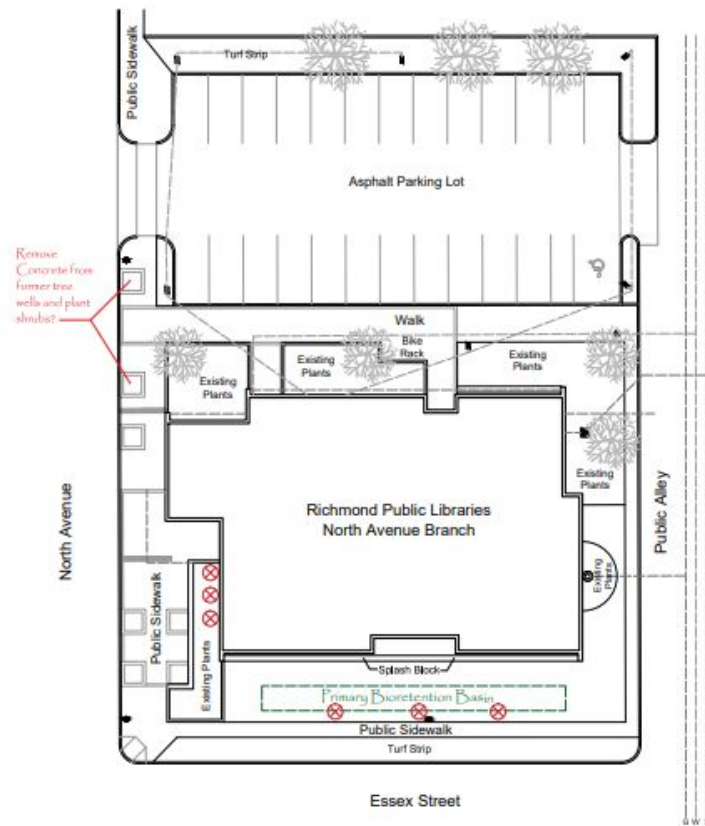

Existing Conditions of North Avenue Branch Library



Existing Conditions - Parking Area



Existing Conditions - Main Entrance



Existing Conditions - Main Entrance



Existing Conditions - Main Entrance



Existing Conditions - Alley



Existing Conditions - E. Essex Street



Existing Conditions - E. Essex Street



Existing Conditions - E. Essex Street



Existing Conditions - North Avenue/E. Essex Street



Existing Conditions - North Avenue



Native, Non-Native, and Invasive Plants

- Native plants are preferred as they are adapted to thrive in our area and provide food and habitat for wildlife, such as insects and birds
- Non-native plants have little ecological value and invasive plants outcompete native plants
- Non-native plants found on library grounds include crape myrtles, Chinese holly, Japanese barberry, liriope, nandina, and winged euonymus



Summary of Existing Conditions

- Impervious asphalt parking area with no shade trees
- Opportunities exist for outdoor seating areas for library visitors
- Preferred location of the bioretention area is along E. Essex Street
- Library window facing E. Essex Street presents an opportunity
- Empty tree wells along North Avenue are opportunities to plant street trees
- Landscaping consists of non-native plant species