

Greening Richmond Public Libraries

East End Branch Library Existing Conditions

Thursday, June 16, 2022



Altria



Greening Richmond Public Libraries

- The James River Association is working alongside Richmond Public Library, Richmond Department of Public Utilities/RVAH2O, and Four Winds Design to plan, design, and install **green infrastructure** to manage stormwater runoff at East End Branch
- The planning and design team is seeking input on **green infrastructure** and outdoor amenities that could be added around East End Branch
- An in-person public meeting was held at East End Branch yesterday afternoon

What is **Stormwater Pollution**?

- Did you know stormwater runoff is a threat to the health of the James River and its tributaries?
- When rain falls on an impervious surfaces, such as rooftops, roads, and sidewalks, it becomes stormwater
- If stormwater runoff picks up pollutants such as dirt, nutrients from lawn fertilizer, bacteria from pet waste, or toxics like oil from cars as it flows across an impervious surface, it becomes **stormwater pollution**

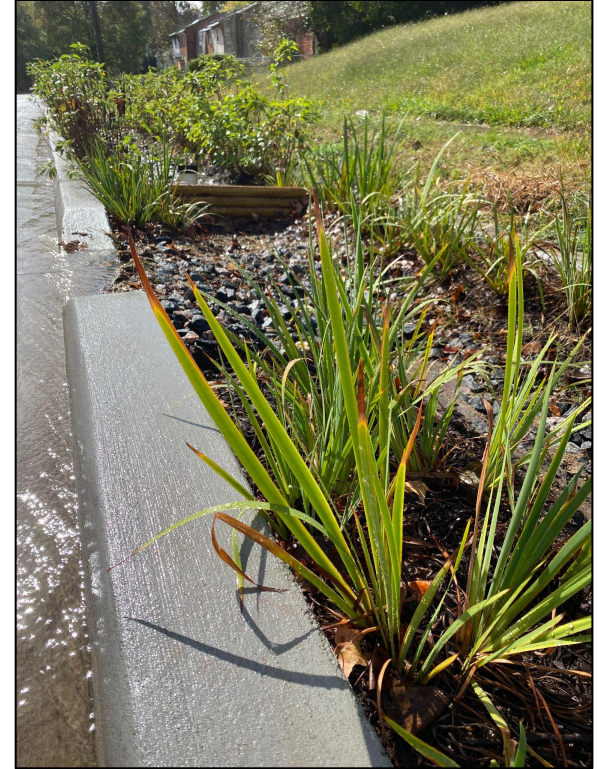

Stormwater entering bioretention area

What is **Green Infrastructure**?

- **Green infrastructure** includes rain gardens, street trees, and conservation landscaping that enhance our built environment for the benefit of humans and the ecosystem of which we are a part
- **Green infrastructure** contributes to healthier communities by absorbing stormwater before it enters our rivers and streams and reducing the urban heat island effect



Applicable **Green Infrastructure** Practices

- Bioretention areas
- Conservation landscaping



- Street trees
- Pervious pavers



Bioretention Basins at RPL Branches



West End Branch



North Avenue Branch

East End Branch Library

- Located at 1200 N. 25th Street in Richmond's East End
- Opened in 1965
- Serves residents of Church Hill, Creighton Court, Fairfield Court, Fairmount, Fulton, Mosby Court, Oakwood, Shockoe Bottom, Union Hill, and Whitcomb Court



Greening Richmond Public Libraries

IMPROVING THE HEALTH OF THE JAMES RIVER BY REDUCING STORMWATER POLLUTION

East End Branch Library

1200 North 25th Street, Richmond, 23223

Legend:

- Backflow preventer
 - Water Meter
 - Gas Meter
 - Electric Meter
 - City Water Sampling Station
 - City Street Lights
 - City Utility Pole
 - Hose Bib
 - City Electrical Vault
 - Gas Vault
 - Clean out
 - Underground electrical line, abandoned
 - Underground electrical line
 - Overhead electrical line
 - Underground gas line
 - Underground sewer line
 - Underground water line
- Existing Invasive Species or diseased/declining plants To Be Removed:
- Existing Trees & Shrubs To Be Preserved:

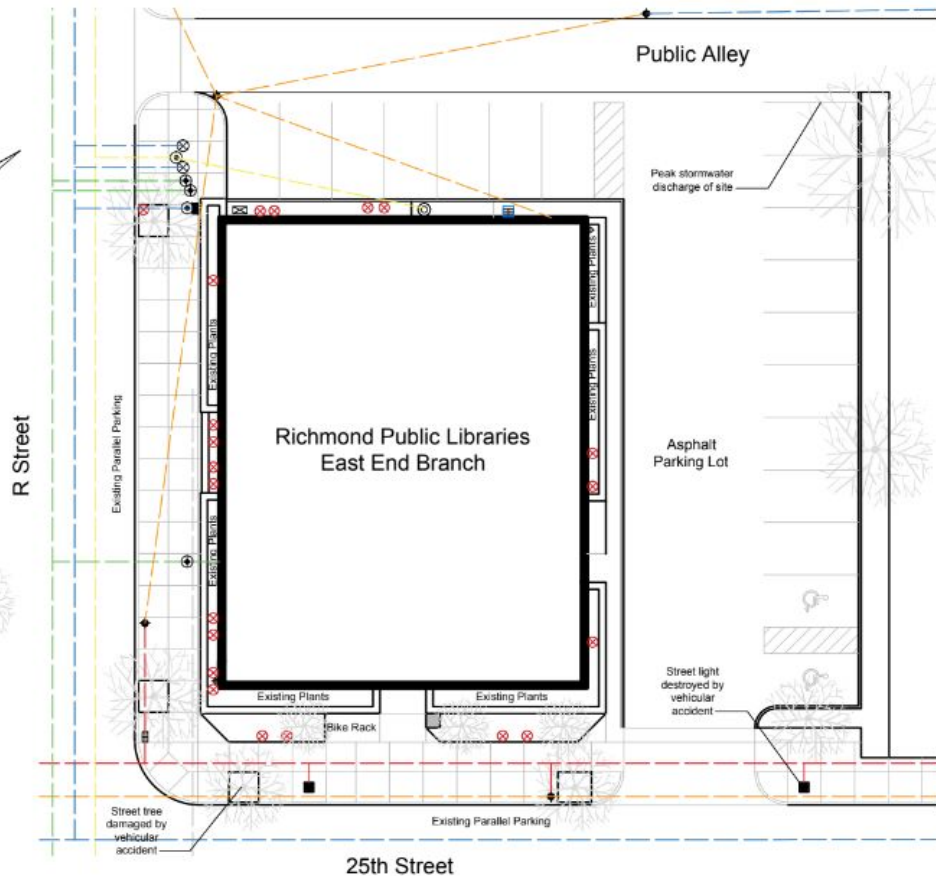

Existing Conditions at East End Branch Library



Existing Conditions - R Street



Existing Conditions - Alley



Existing Conditions - Parking Area



Non-Native Plants at East End Branch library

- Non-native plants have little ecological value and if they are invasive can outcompete native plants
- Native plants are preferred as they are adapted to thrive in our area and provide food and habitat for wildlife, such as insects and birds
- Non- native plants on library grounds will be removed and replaced with native plants



Summary of Existing Conditions

- Utilities may limit what can be designed and implemented
- Preferred location of bioretention areas is along N. 25th and R Streets
- Opportunities exist for outdoor seating along N. 25th and R streets
- Alley behind the library presents an opportunity for a green alley
- Impervious asphalt parking area has limited tree canopy
- Vehicular traffic on N. 25th Street is a safety concern
- Existing landscaping consists of both native and non-native plant species