



JAMES A. BUZZARD RIVER EDUCATION CENTER

Event Rental Guide



2825 DOCK ST, RICHMOND, VA 23223 • THEJAMESRIVER.ORG • EVENTS@THEJAMESRIVER.ORG

The James A. Buzzard River Education Center opened in July 2024 as a facility that connects the Greater Richmond community to the James River. Located between Great Shiplock Park and Dock Street Park, the Jim Buzzard Center features elevated views of the James River in a history-rich location within walking distance of Downtown Richmond, the Low Line and the Virginia Capital Trail.

The Jim Buzzard Center serves as the hub for JRA's Richmond-area educational programming and a living example of sustainable infrastructure. It was designed with a strong emphasis on sustainability and flood resiliency, given its immediate proximity to the James River. The building is organized into three elevation-based zones, each with material and design choices tailored to mitigate flood risk and reduce impact on the surrounding environment. It is available on select dates and times for private and corporate events.

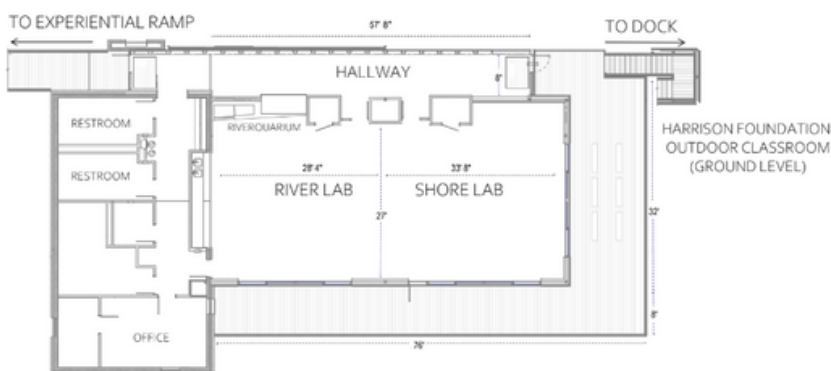

JAMES RIVER ASSOCIATION
JAMES A. BUZZARD RIVER EDUCATION CENTER

Capacity: The approximately 1700 square foot interior can be divided into two separate areas. Additional space is available on the exterior deck with panoramic views of the James River.

Seated at rounds: 80 people

Cocktail: 95 people

Classroom using lab tables and stools: 48 people

Seminar: 90 people

On-site parking includes three spaces for personal vehicles and space for up to two commercial buses. Additional street parking and public parking can be found within walking distance of the center. For larger events, parking shuttles and nearby satellite lots are available for an additional cost. JRA encourages walking, biking (the center is along the Virginia Capital Trail!), public transit (free GRTC Pulse bus stops are within walking distance), and rideshare.



Available Amenities:

- 10 5' round seating tables, six 6' rectangular banquet tables and 90 black ergonomic chairs
- Flexible classroom set-up of 14 lab tables and 48 stools
- Outdoor classroom space, including 3 picnic tables
- A/V equipment
- Free wifi
- Freezer and refrigerator

JAMES A. BUZZARD RIVER EDUCATION CENTER PRICING

weekday meetings (8am-5pm) 3 hour event*	\$500
weekday special events (8am-5pm) 5 hour event*	\$1,000
weeknight meetings (4pm-10pm) 4 hour event*	\$1000
weeknight special events (4pm-10pm) 6 hour event*	\$1,500
weekend (Saturday & Sunday) events 8 hour event*	\$2,000
*hours include set-up and tear-down time. Additional hours available at \$200/hour. Inquire for multi-day event and wedding rates. Non-profit & partner discounts are available for weekday rentals.	



Contact us for a tour to see how your event can connect to the James River!
Jen Strife • Events Coordinator • events@thejamesriver.org
Preferred vendors for catering, rentals and transportation provided upon request.

YOU'RE SUPPORTING OUR WORK

Our rental program helps to support our operations and educational programming while increasing awareness of our mission in the community.



PROTECT

JRA's restoration teams work across the watershed to improve water quality, restore shorelines, plant trees, and manage stormwater runoff and other pollutants. In addition, our Advocacy team fights for policies and funding for clean water programs that protect and restore the James.



CONNECT

Our education programs provide more than 20,000 student interactions a year and deliver life-changing opportunities for students to experience the river. Across our three regional river centers, including the James A. Buzzard River Education Center, we're building the next generation of conservationists and river stewards.



BE A JAMES CHANGER! MAKE A ONE-TIME OR SUSTAINING GIFT TO SUPPORT JRA AND ENSURE THE FUTURE OF OUR PROGRAMMING.

LEARN MORE AT WWW.THEJAMESRIVER.ORG